

 **TILTON**
COFFERED CEILINGS
Easy to Design | Simple to Install | Beautiful to Behold



SHALLOW BEAM COFFERED CEILING KIT
Installation Manual
Pattern Kits Using Classic XL or Geometric Intersection Fittings
(Straight Orientation)

800-396-6410

www.tiltoncofferedceilings.com



CONTENTS

NECESSARY & SUGGESTED INSTALLATION TOOLS

What You Will Need 1

KIT COMPONENTS & TERMINOLOGY

What's Included 2

INSTALLATION PROCESS

Measure & Mark 3

Install 4-5

INSTALLATION FIGURES

Figures 1 & 2 6

Figures 3 & 4 7

Figures 5A & 5B 8

Figures 5C-1 & 5C-2 9

Figures 6A & 6B 10

Figures 7A & 7B 11

Figures 7C-1 & 7C-2 12

Figures 8A & 8B 13

Figures 8C-1 & 8C-2 14

Figures 9A & 9B 15

Figures 9C-1 & 9C-2 16

NECESSARY & SUGGESTED INSTALLATION TOOLS

WHAT YOU WILL NEED

HAND TOOLS & EQUIPMENT

- Tape Measure (25' to 30' or Laser Measure suggested)
- Pencil or Marking Device
- Chalk Line
- 7" or 12" Speed Square
- Step Ladders and/or Staging and Scaffolding (*depending on the ceiling height*)
- Caulk Gun

POWER TOOLS

- Miter/Chop Saw
- 16ga or 15ga Pneumatic or Cordless Finish Nail Gun
- Cordless Drill/Driver (*impact type recommended*)

DIGITAL & ELECTRONIC TOOLS

- Laser Measure (*optional*)
- Stud Finder (*optional*)

KIT COMPONENTS & TERMINOLOGY

WHAT'S INCLUDED

INNER BEAM FITTINGS - Beam connectors with two (2) profiled edges.

PERIMETER MOLDING - Molding used around the entire perimeter of the ceiling to create a neat finish to the surrounding walls. (*optional*)

INSTALLATION PROCESS

MEASURE & MARK

STEP 1. Measure the length of each side of the ceiling and divide each dimension in half to determine the center points for each. Mark the center point for each side with a straight line on the ceiling using a square and pencil.

(see Figures 1 and 2)

STEP 2. Using a chalk reel, snap a single chalk line to connect the center point marks from both long sides of the ceiling and snap a second single chalk line to connect the center point marks from both short sides of the ceiling. The point at which these two lines intersect is the center axis of the ceiling.

(see Figure 3)

INSTALL

STEP 1. Measure and cut the optional Perimeter Moldings to length for each wall. Apply adhesive to the back side and position the moldings against the wall with the top edge tight to the ceiling. Fasten the molding to the wall studs using 2-½" long 16ga or 15ga finish nails driven through the face of the flat portion of it. Continue this process on all walls until the entire perimeter is complete.

(see Figure 4)

Follow SEGMENT 'A' below if you want your beam pattern to have an intersection of beams at center of the ceiling

(see Figure 9A)

Follow SEGMENT 'B' below if you want your beam pattern to have a full coffer at the center of the ceiling

(see Figure 9B)

Follow SEGMENT 'C' below if you want your beam pattern to have a single beam at center of the ceiling

(see Figure 9C-1 and 9C-2)

SEGMENT 'A'

(If you want an intersection of beams at the center of the ceiling)

STEP A1. Apply construction adhesive to the back side of the first Intersection Fitting and position it on the ceiling so that the integrated centerline grooves are aligned with the ceiling center axis chalk lines made in step 1.

(see Figure 5A)

Once in position and aligned properly, secure the Fitting with 2 ½" long finish nails driven at an angle through the large cove portion of the profiled edges and into the ceiling substrate and/or structure (i.e. drywall and/or framing joists).

(see Figure A1 and B1)

STEP A2. Once the first Intersection Fitting has been fastened to the ceiling, repeat the process of installing each of the subsequent full Intersection Fittings (those not requiring to be cut) by applying adhesive to the back side and aligning the integrated centerline grooves and/or the square ends of each with the ceiling center axis chalk lines and/or the Fitting(s) installed before it. Fasten each Fitting in the same manner as described for the first one until all of the full Fittings have been installed securely to the ceiling.

(see Figure 6A and 7A)

STEP A3. Measure, mark and cut the remaining Intersection Fittings to fill the remaining areas between all of the full Fittings and the surrounding walls or optional Perimeter Molding.

Repeat the process of installing each of the partial Intersection Fittings (those requiring to be cut) by applying adhesive to the back side and aligning the integrated centerline grooves and/or the square ends of each with the ceiling center axis chalk lines and/or the Fitting(s) installed before it. Fasten each Fitting in the same manner as described for the first one until all of the partial Fittings have been installed securely to the ceiling.

(see Figure 8A)

SEGMENT 'B'

(when you want a full coffer at the center of the ceiling)

STEP B1. Apply construction adhesive to the back side of the first Intersection Fitting and position it on the ceiling so that two (2) of the square ends that are perpendicular (90 degrees) to one another are aligned with each of the ceiling center axis chalk lines made in step 1.

(see Figure 5B)

Once in position and aligned properly, secure the Fitting with 2 ½" long finish nails driven at an angle through the large cove portion of the profiled edges and into the ceiling substrate and/or structure (i.e. drywall and/or framing joists).

(see Figure A1 and B1)

STEP B2. Once the first Intersection Fitting has been fastened to the ceiling, repeat the process of installing each of the subsequent full Intersection Fittings (those not requiring to be cut) by applying adhesive to the back side and aligning the square ends of each with the ceiling center axis chalk lines and/or the Fitting(s) installed before it. Fasten each Fitting in the same manner as described for the first one until all of the full Fittings have been installed securely to the ceiling

(see Figure 6B and 7B)

STEP B3. Measure, mark and cut the remaining Intersection Fittings to fill the remaining areas between all of the full Fittings and the surrounding walls or optional Perimeter Molding.

Repeat the process of installing each of the partial Intersection Fittings (those requiring to be cut) by applying adhesive to the back side and aligning the square ends of each with the ceiling center axis chalk lines and/or the Fitting(s) installed before it. Fasten each Fitting in the same manner as described for the first one until all of the partial Fittings have been installed securely to the ceiling.

(see Figure 8B)

SEGMENT 'C'

(If you want a single beam at the center of the ceiling)

STEP C1. Apply construction adhesive to the back side of the first Intersection Fitting and position it on the ceiling so that the integrated centerline grooves are aligned with one of the two ceiling center axis chalk lines and one of the square ends is aligned with the other center axis chalk line perpendicular to it made in Step 1.

(see Figures 5C-1 and 5C-2)

Once in position and aligned properly, secure the Fitting with 2 ½" long finish nails driven at an angle through the large cove portion of the profiled edges and into the ceiling substrate and/or structure (i.e. drywall and/or framing joists).

(see Figures A1 and B1)

STEP C2. Once the first Intersection Fitting has been fastened to the ceiling, repeat the process of installing each of the subsequent full Intersection Fittings (those not requiring to be cut) by applying adhesive to the back side and aligning the integrated centerline grooves and/or the square ends of each with the ceiling center axis chalk lines and/or the Fitting(s) installed before it. Fasten each Fitting in the same manner as described for the first one until all of the full Fittings have been installed securely to the ceiling

(see Figures 6C-1, 6C-2, 7C-1 and 7C-2)

STEP C3. Measure, mark and cut the remaining Intersection Fittings to fill the remaining areas between all of the full Fittings and the surrounding walls or optional Perimeter Molding.

Repeat the process of installing each of the partial Intersection Fittings (those requiring to be cut) by applying adhesive to the back side and aligning the integrated centerline grooves and/or the square ends of each with the ceiling center axis chalk lines and/or the Fitting(s) installed before it. Fasten each Fitting in the same manner as described for the first one until all of the partial Fittings have been installed securely to the ceiling

(see Figures 8C-1 and 8C-2)

OVERALL INSTALL NOTES:

- When fastening the Beam Fittings with nails it is recommended to locate and nail into the ceiling joists where applicable for added strength and stability. In addition to nails, you may also pre-drill and countersink #8 x 3" long trim head screws into the flat 5 1/2" wide face area of the Fittings to secure them to the ceiling joists.

(see Figure A2)

- Shim the back sides of the Beam Fittings as needed to achieve precise alignment of the joints as well as to keep them straight and level against any deflection in the ceiling surface.

(see Figure C1 and C2)

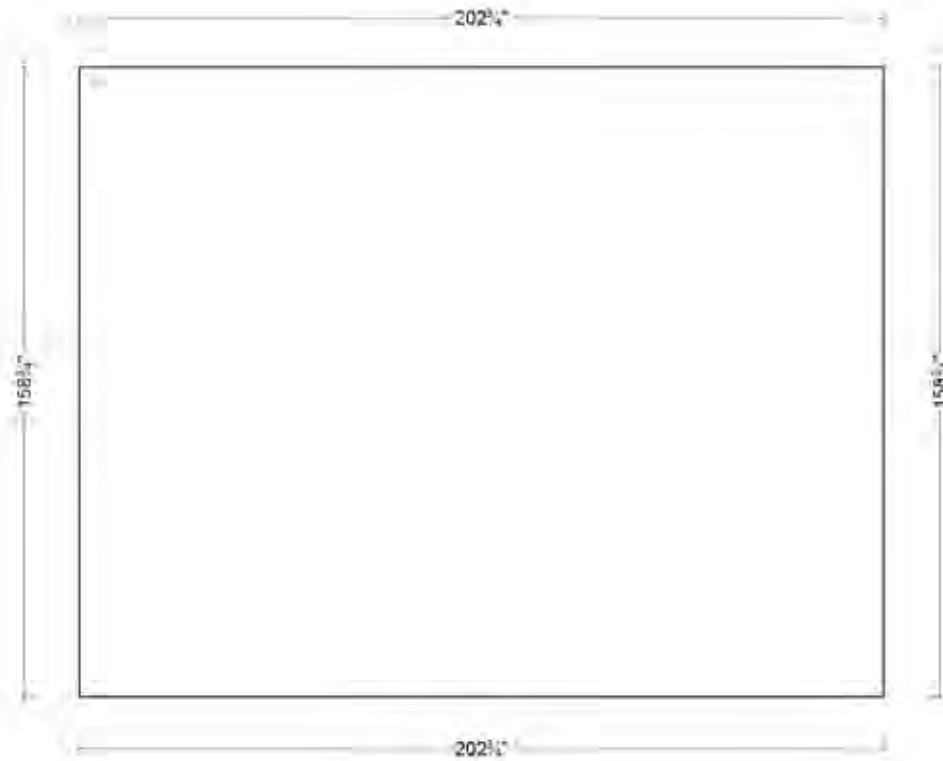

Fig. 1

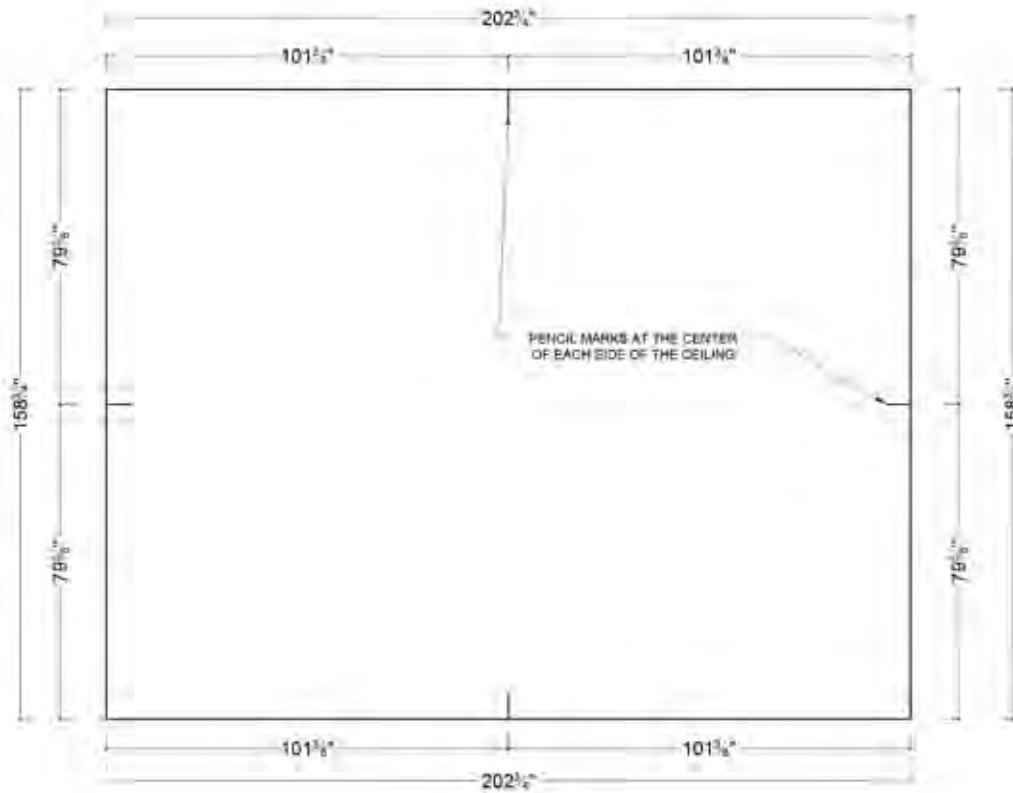

Fig. 2

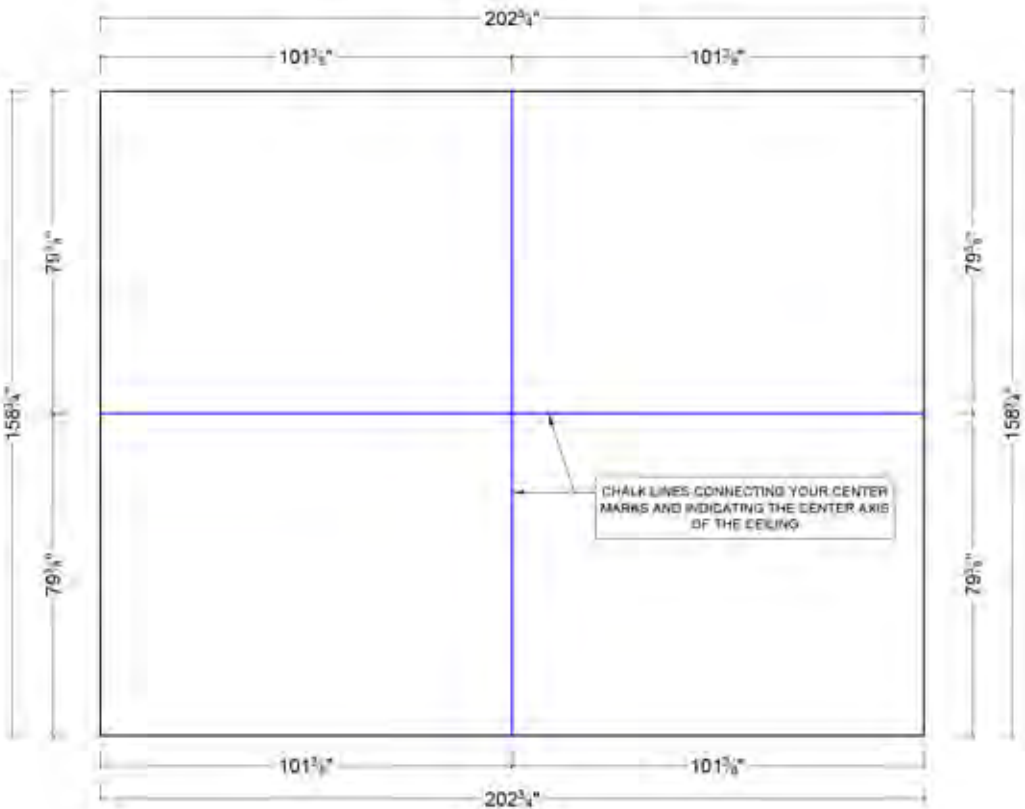

Fig.3

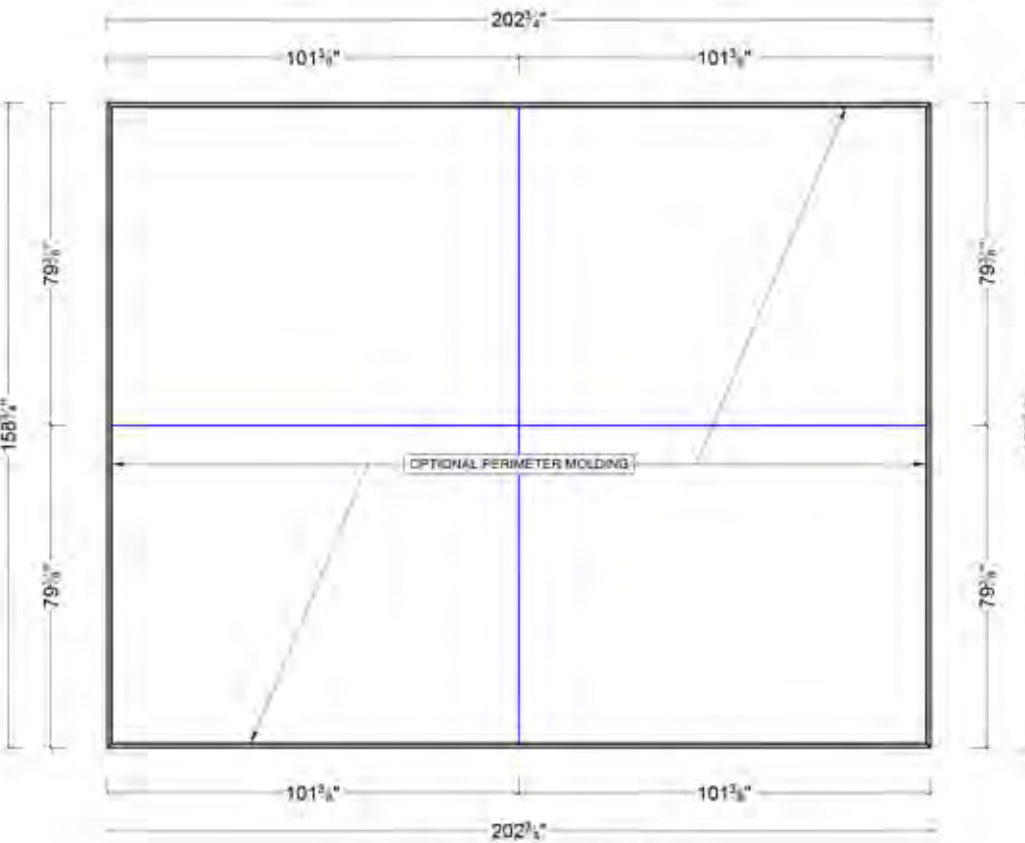

Fig.4 (OPTIONAL)

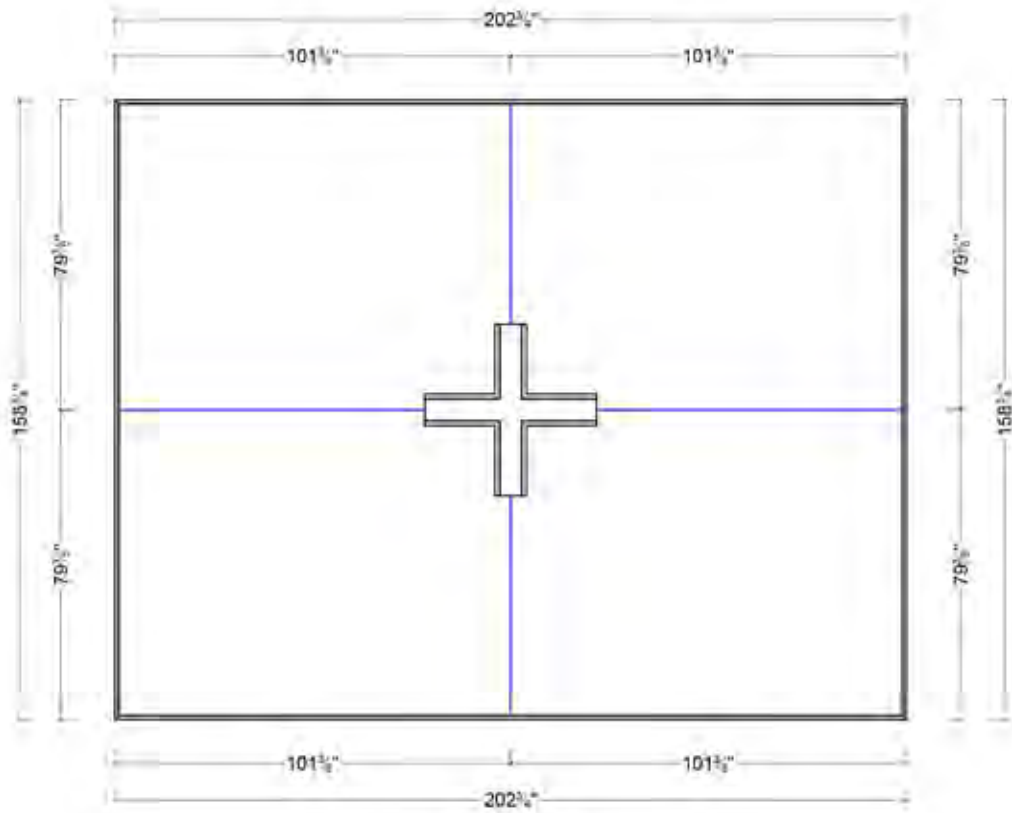

Fig.5A

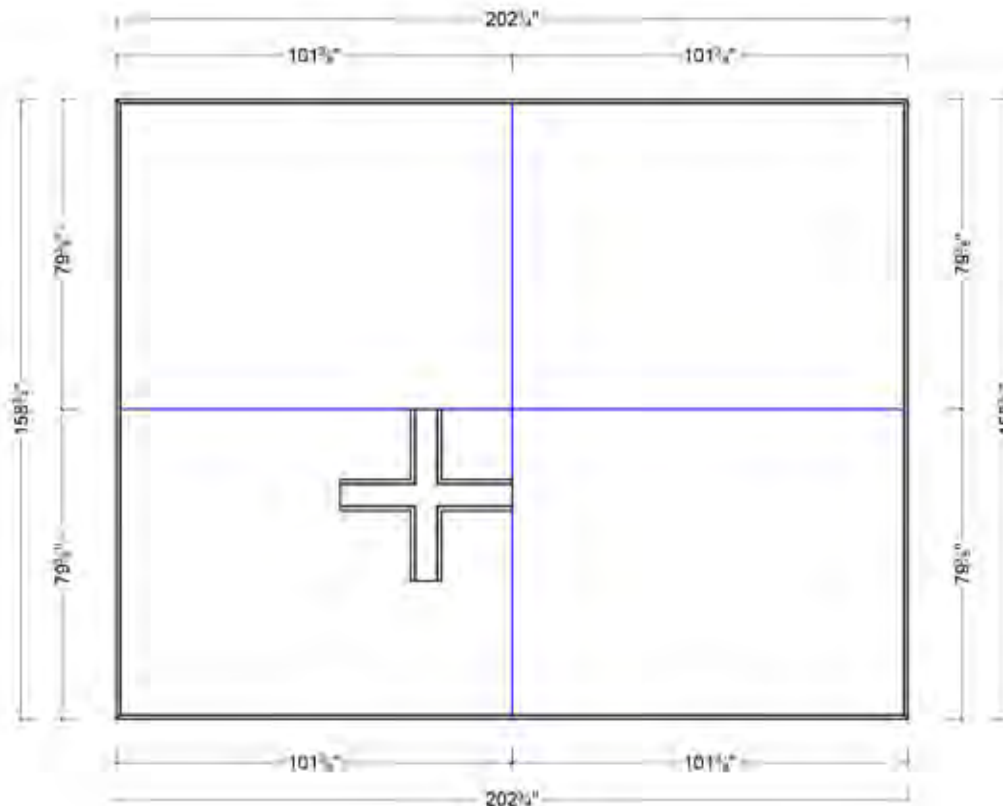

Fig.5B

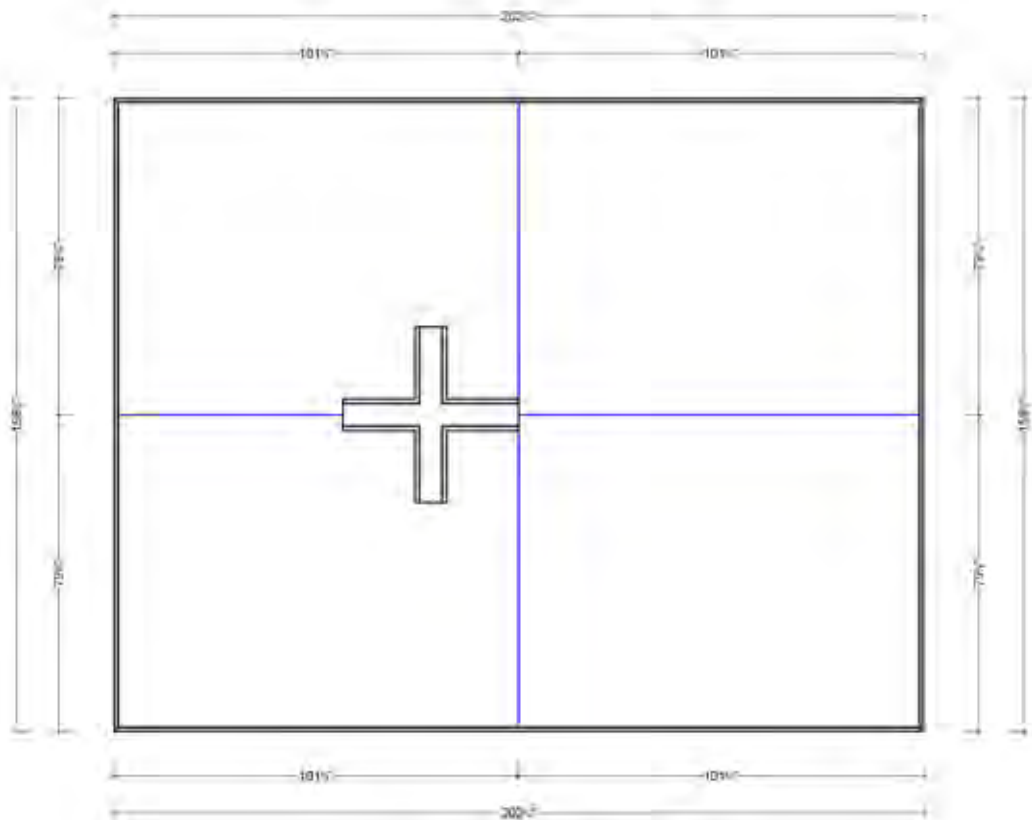

Fig.5C-1

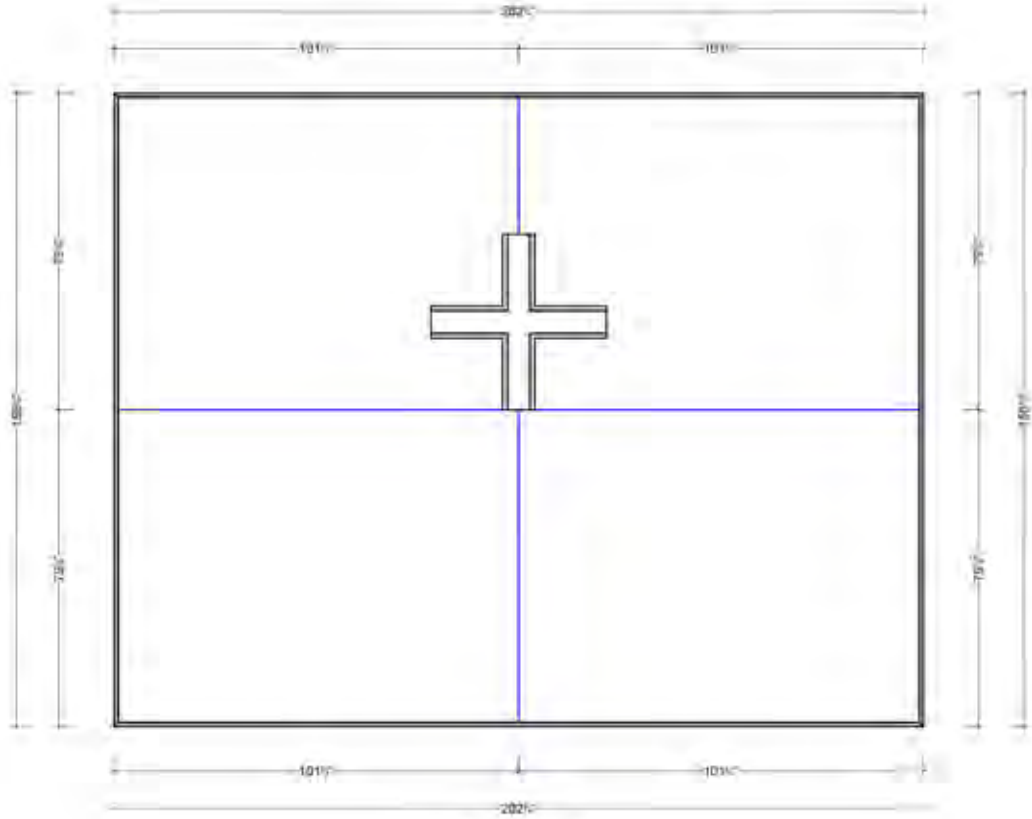

Fig.5C-2

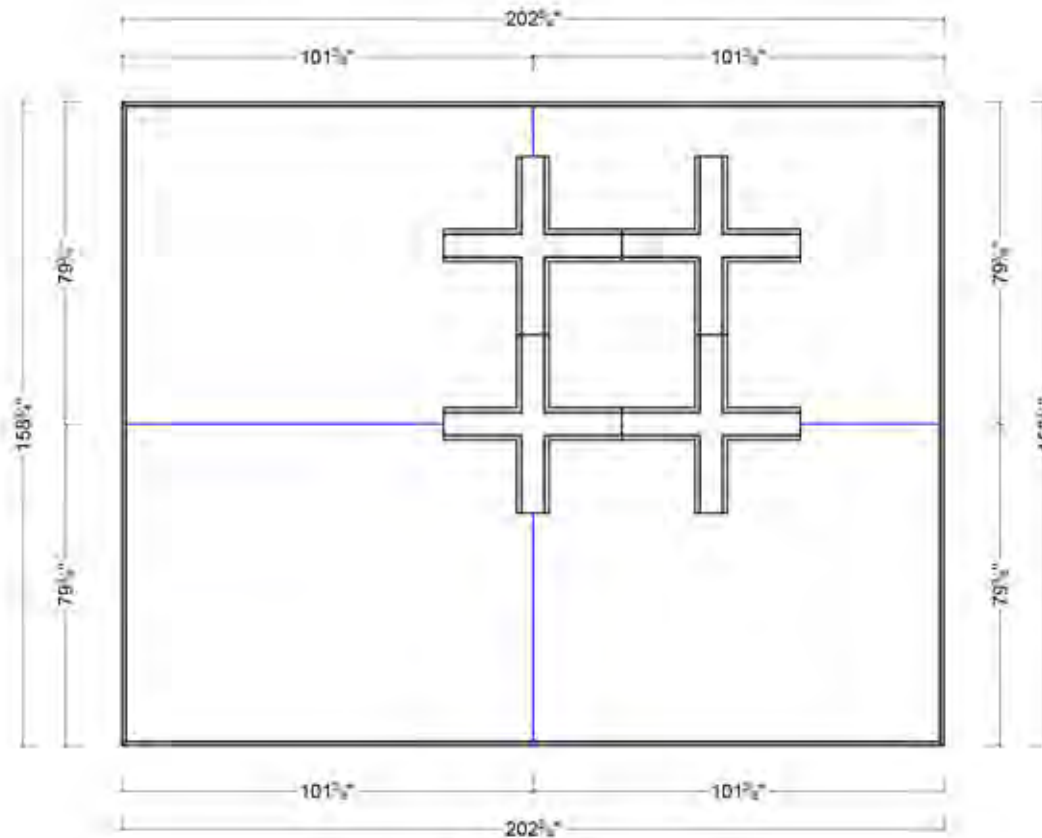

Fig.6A

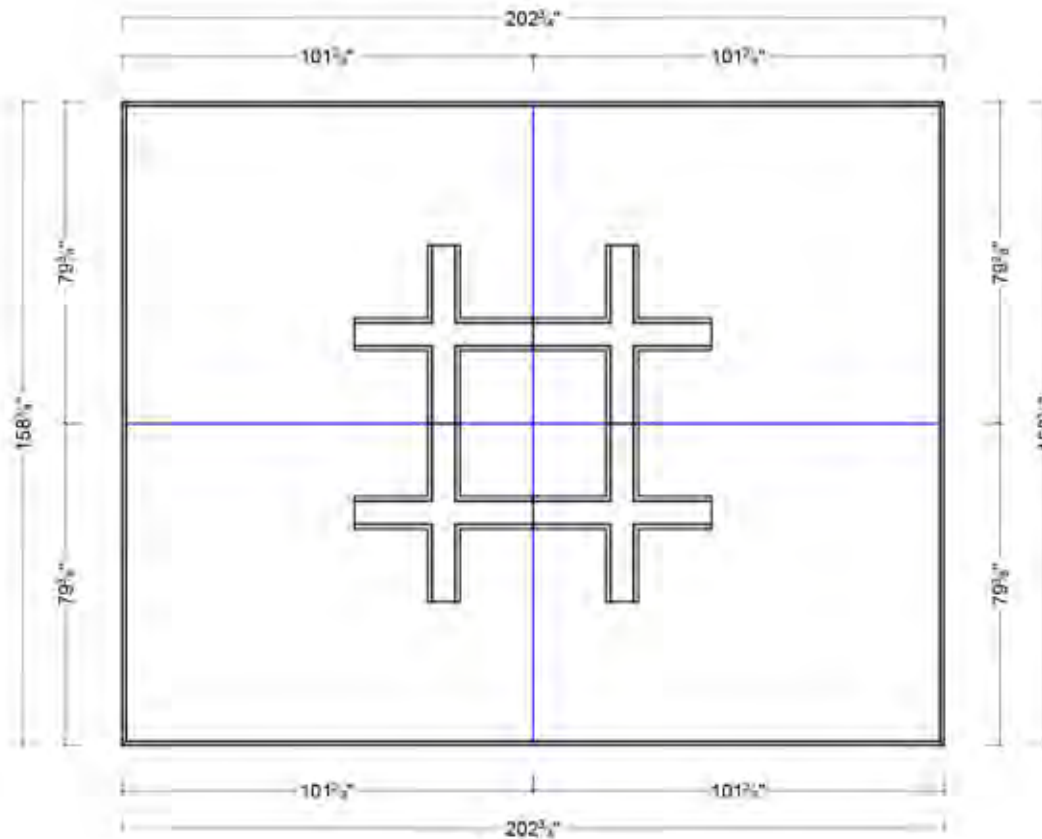

Fig.6B

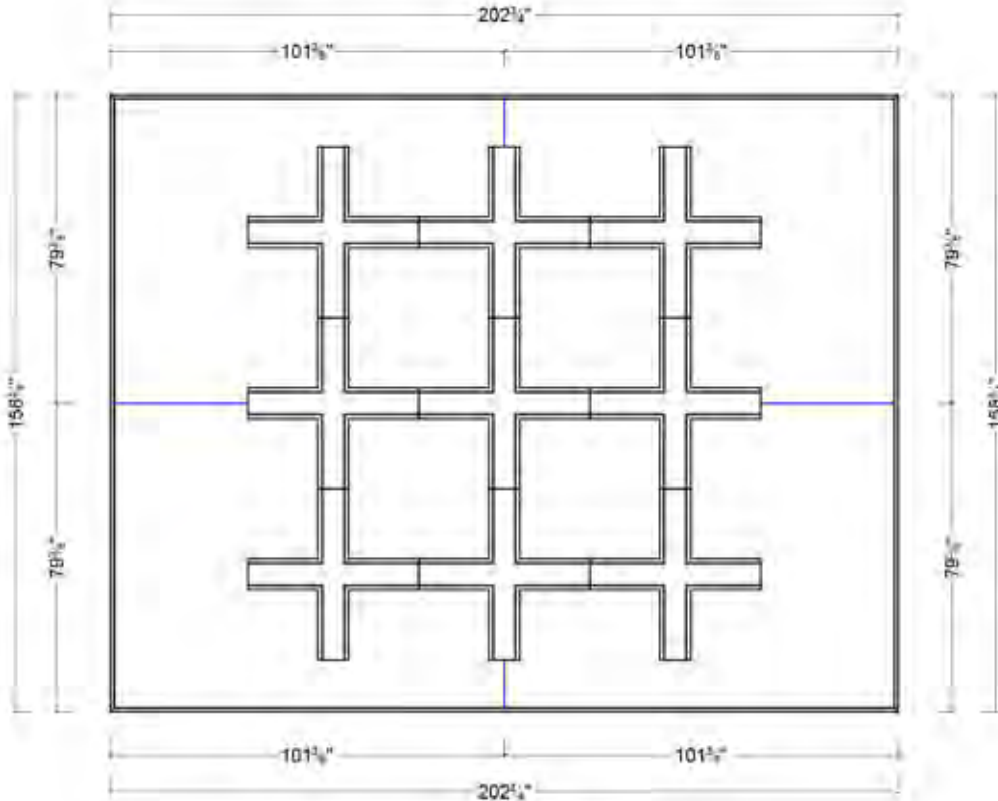

Fig.7A

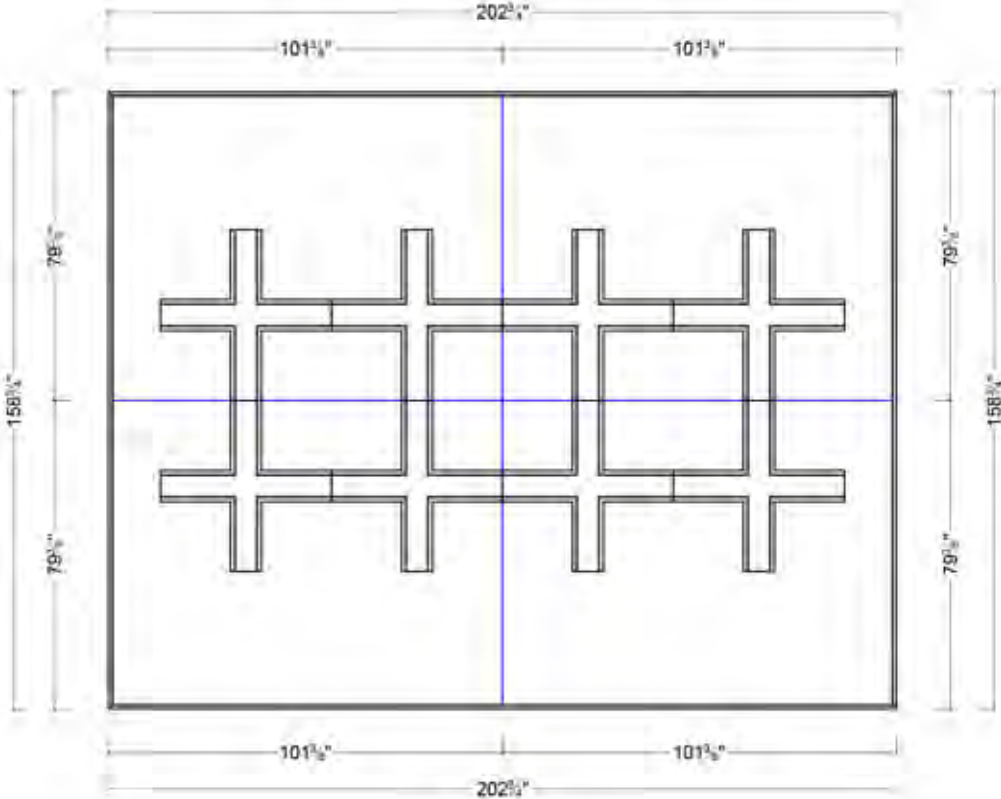

Fig.7B

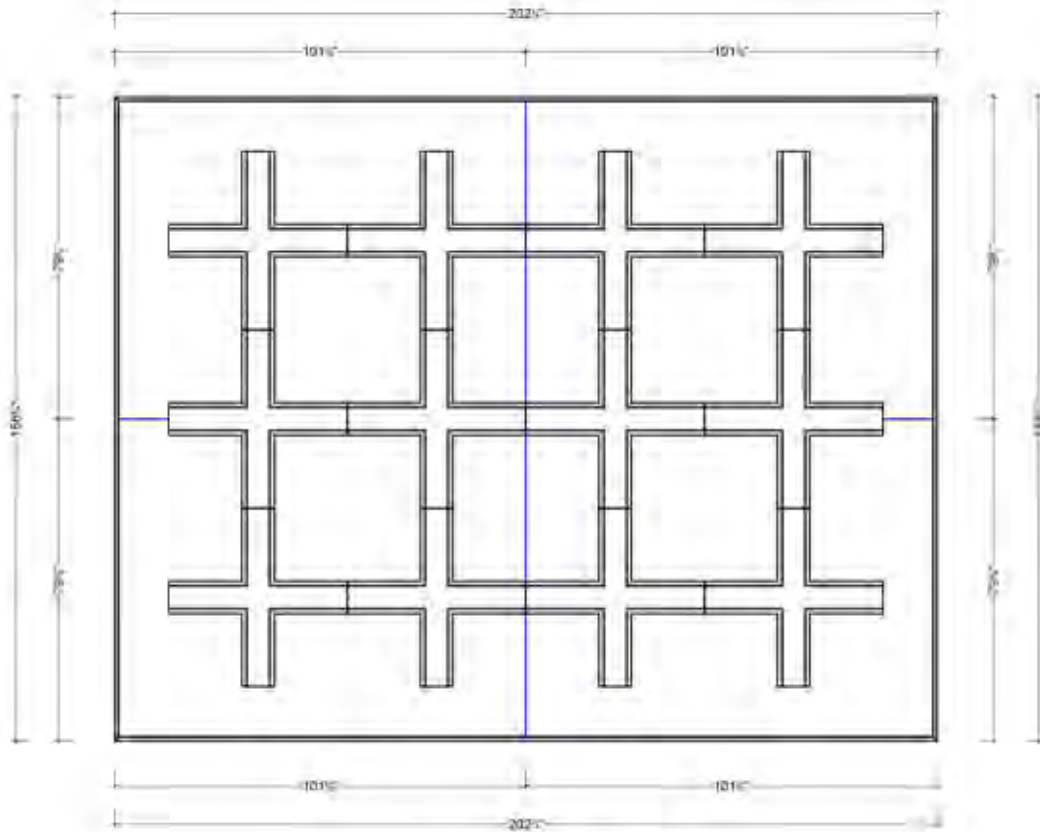

Fig.7C-1

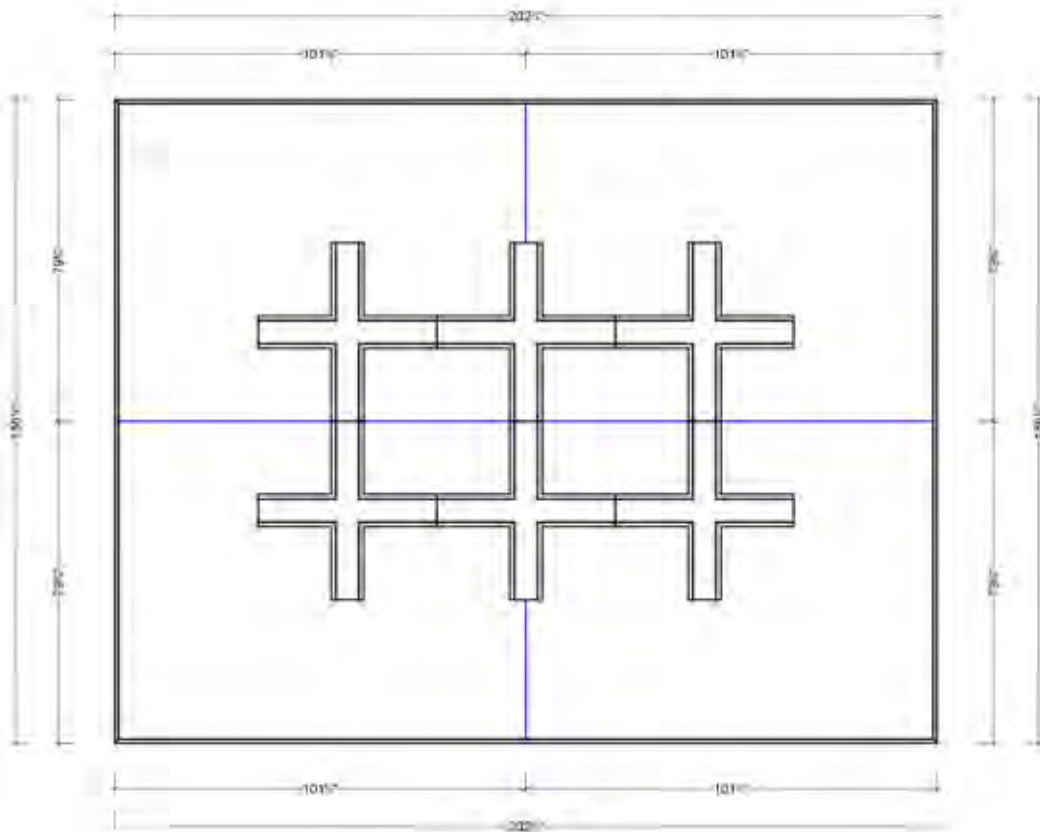

Fig.7C-2

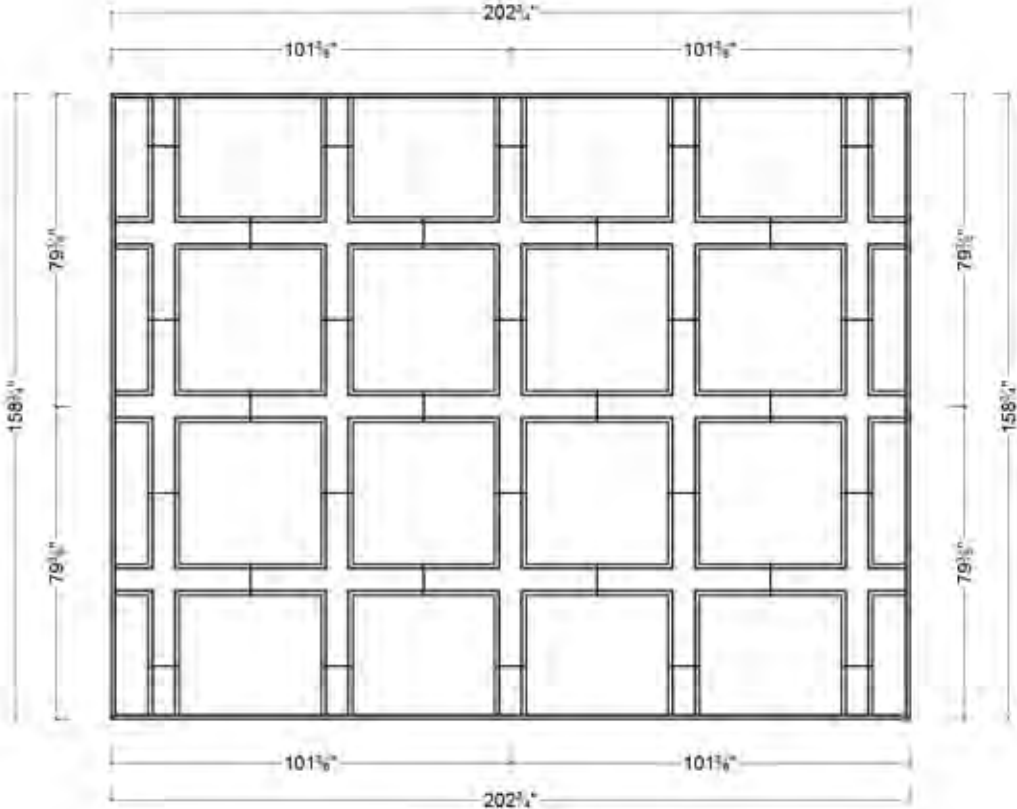

Fig.8A

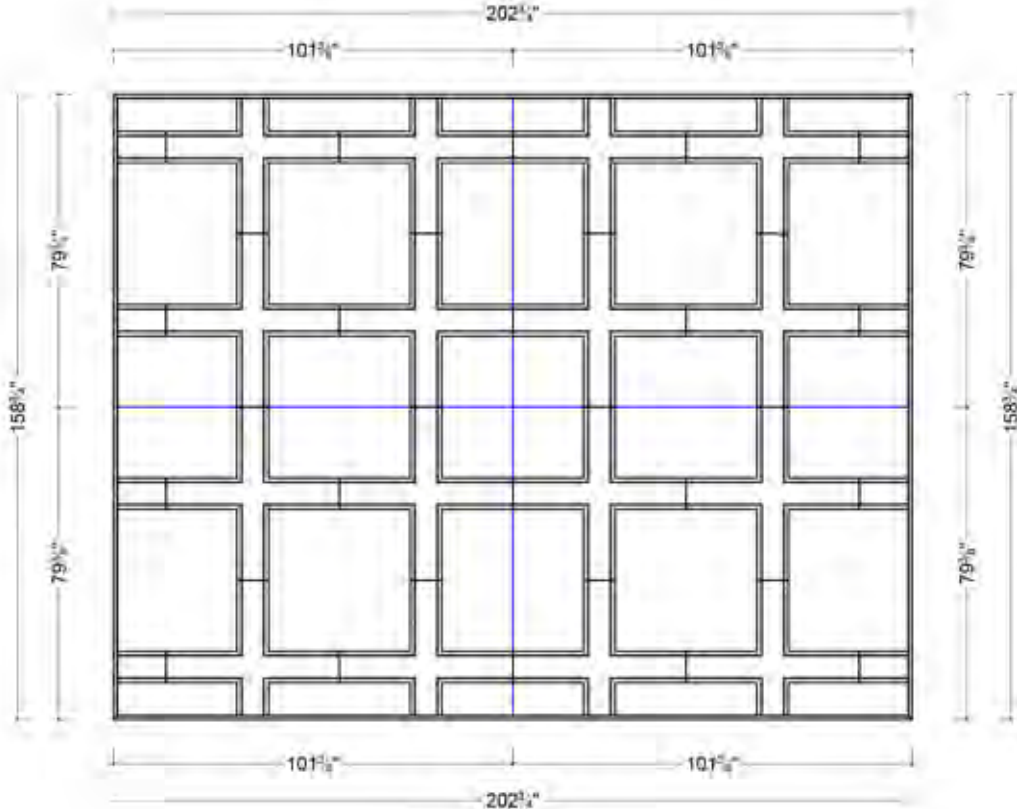

Fig.8B

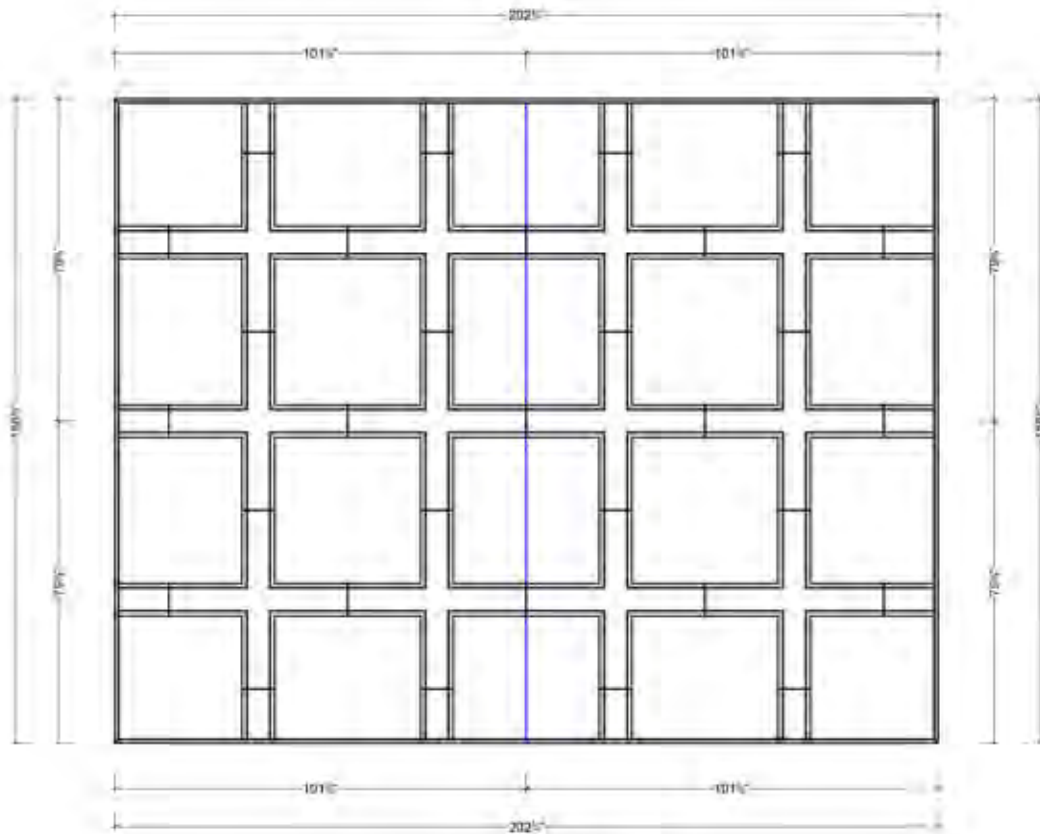

Fig.8C-1

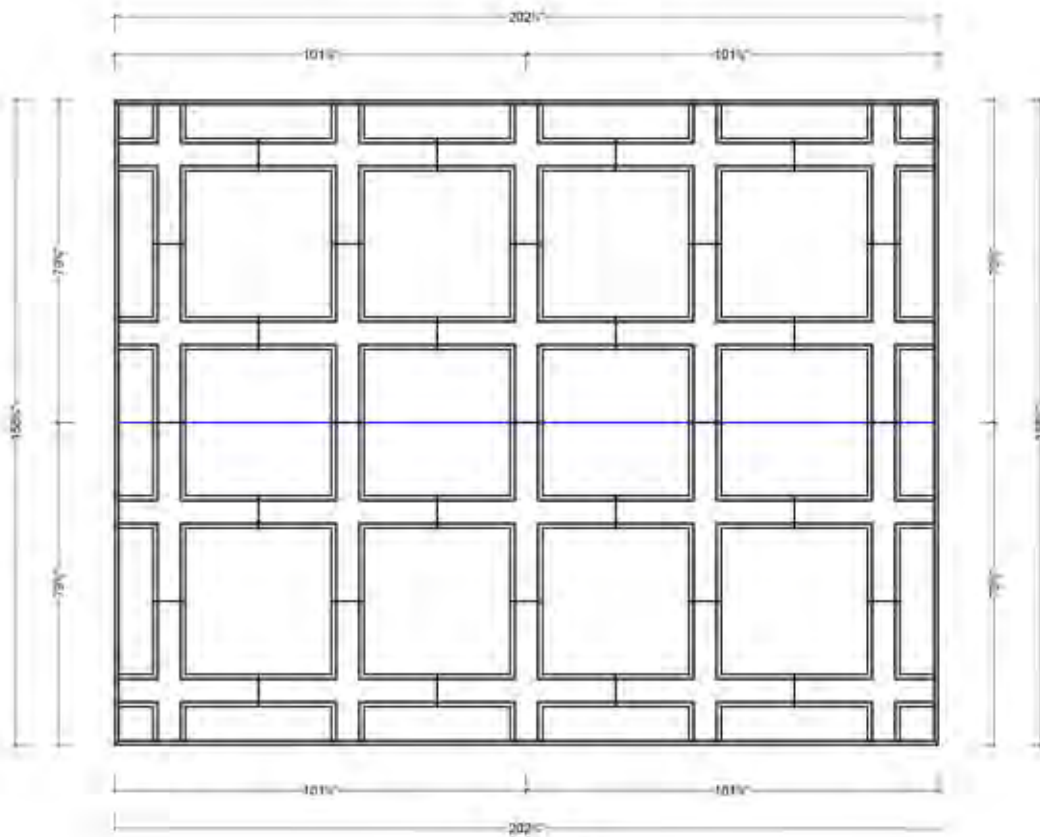

Fig.8C-2

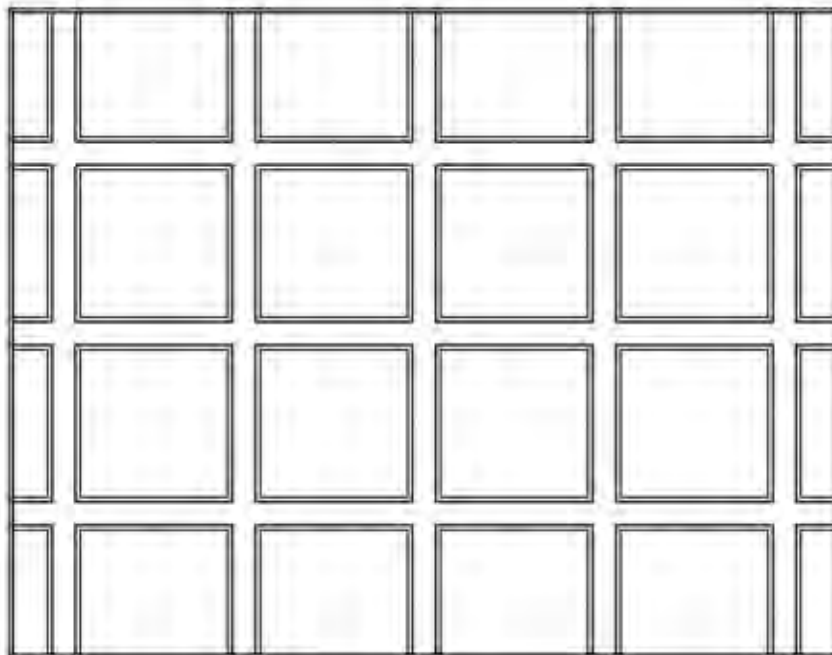

Fig.9A

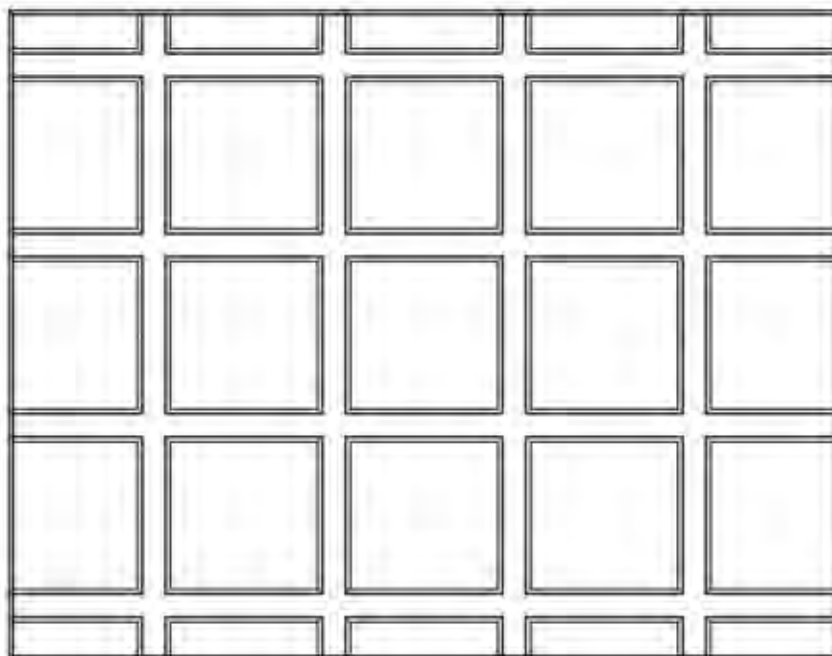

Fig.9B

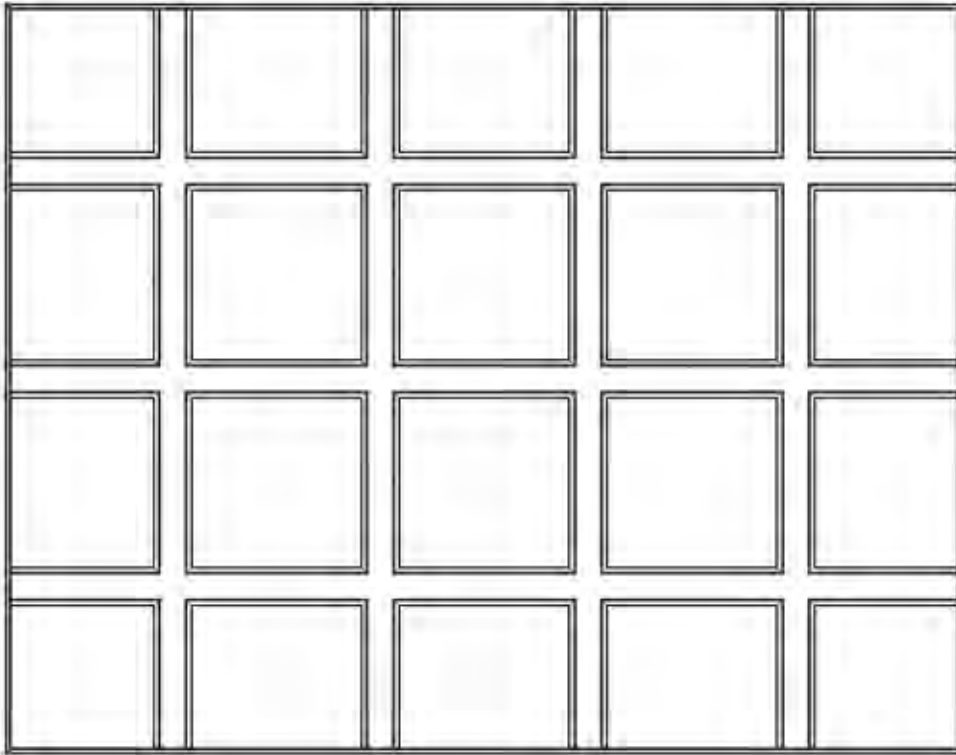

Fig.9C-1

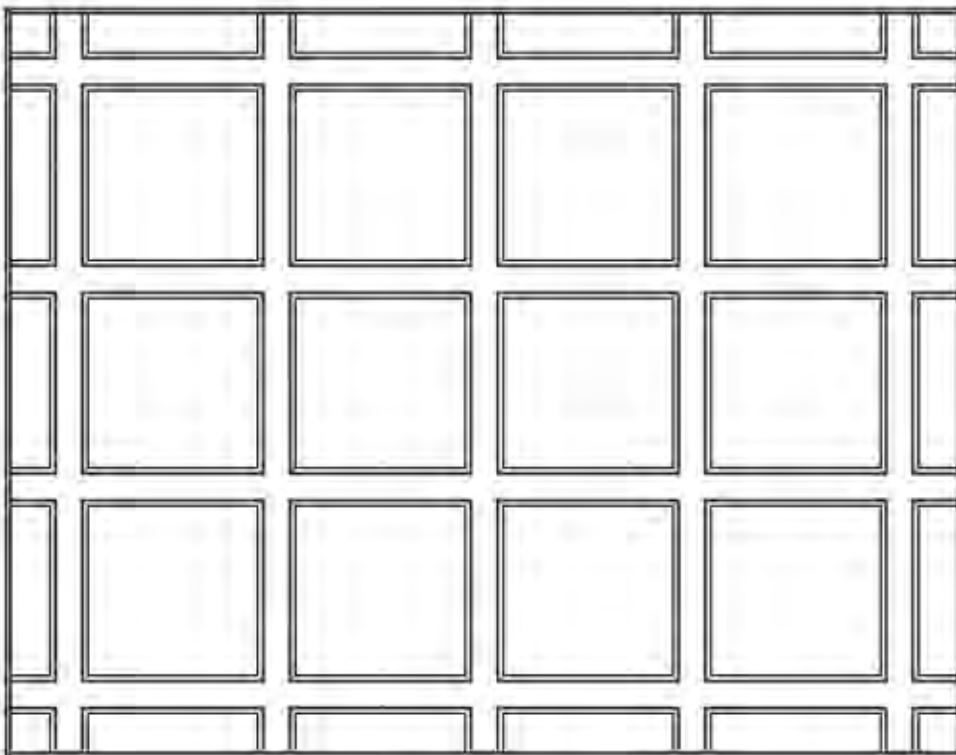

Fig.9C-2